



Bryan Bishop
and partners

Upper Green
Tewin, AL6 0LY



Upper Green

Tewin, AL6 0LY







GROUND FLOOR

Entrance Hall

Living Room

23'4" x 15'10"

W.C

Study

12'0" x 12'0"

Family/Dining Room

12'0" x 27'11"

Kitchen/Breakfast Room

17'3" x 24'6"

Conservatory

11'7" x 13'3"

Utility Room

Larder

Conservatory

23'8" x 22'8"

Garage

26'5" x 10'0"

Store Room

FIRST FLOOR

Landing

Master Bedroom

13'11" x 12'0"

Dressing Room

En-Suite

Bedroom Two

12'0" x 19'8"

Dressing Room

Bedroom Three

12'0" x 12'0"

Family Bathroom

Bedroom Four

15'9" x 15'11"

En-Suite

Bedroom Five

14'10" x 9'9"

Bedroom Six

10'7" x 10'0"

Garage

18'8" x 19'1"

Store Room





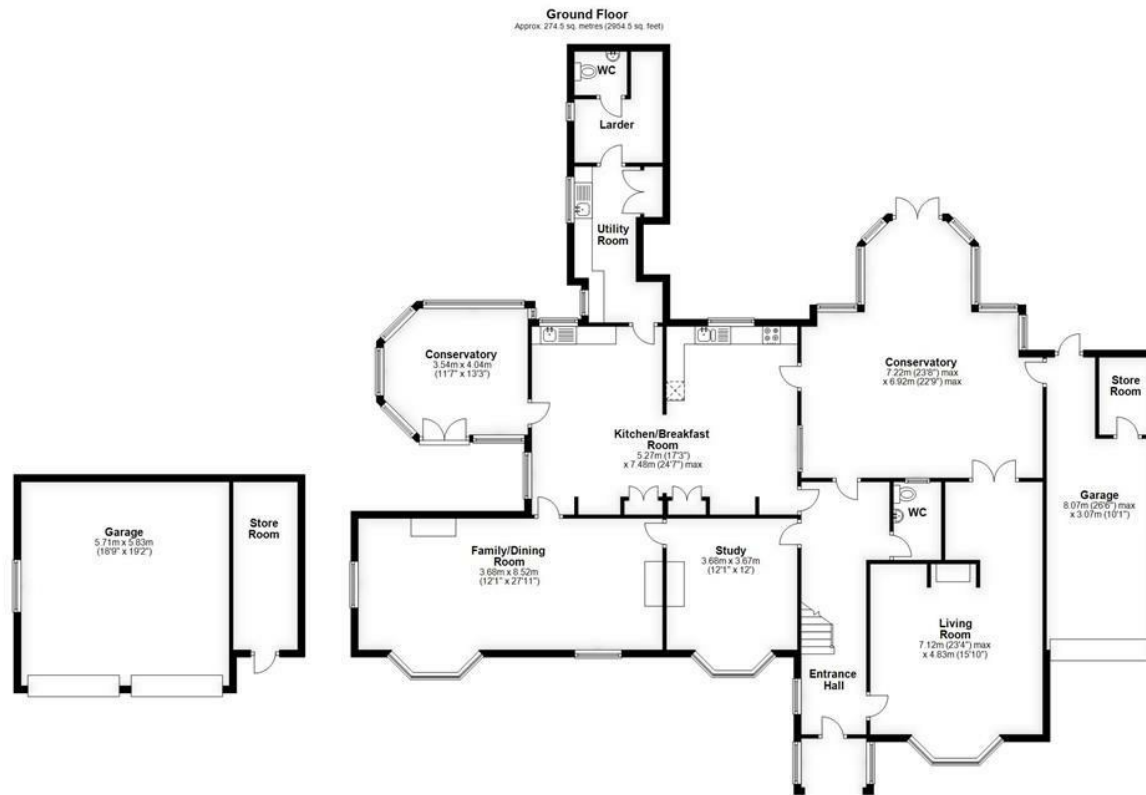

Total area: approx. 433.9 sq. metres (4670.2 sq. feet)

Energy Efficiency Rating		
	Current	Potential
Very energy efficient - lower running costs		
(92 plus) A		
(81-91) B		
(69-80) C		
(55-68) D		
(39-54) E		
(21-38) F		
(1-20) G		
Not energy efficient - higher running costs		
England & Wales		
EU Directive 2002/91/EC		

Bryan Bishop
and partners

6a High Street | Welwyn | AL6 9EG | 01438 718877 | info@bryanbishop.co.uk | www.bryanbishop.co.uk Find us on

